



## LAND455 SYLLABUS

Professor: Brad Goetz

**Catalog Description** LAND 455 05(1-6-1). Education Abroad-European Landscape Architecture. SS. Prerequisite: LAND 362 or consent of instructor. Exploration of major theoretical platforms in design through drawing, photographing, and measuring landscape architecture precedents in Europe.

### Expanded Course Description

This course is intended to give participants direct exposure to the rich history of landscape design in Italy and France. Students will visit many important landscape architectural precedents and pursue research on various topics including land planning, urban design, community design, and insightful garden design for public and private places. Subjects include classical landscapes in and around Rome, medieval hill towns of Tuscany, remarkable private gardens/villas of the renaissance near Florence, royal parks of Louis XIV in central France, WWII landscapes of Normandy, and modern public gardens of Paris. This course is taught in a study abroad short course travel format in order to better understand the culture and true complexity and scale of important landscape architectural works – TO SEE FOR YOURSELF.

## E d u c a t i o n a l   O b j e c t i v e s

Students will develop professional capabilities for landscape design practice, theory, and representation.

Students will explore cultural and natural history of landscapes in Europe.

Students will better understand the complex set of relationships required to realize works of landscape architecture.

Students will experiment with techniques (including digital) for project research, analysis, synthesis, and evaluation.

Each student will prepare a digital portfolio of works for the class as required by ASLA LAAB accreditation standards.

Mode of Delivery: Classroom instruction, travel (field study), mixed media/interactive technology. The field study component of this course will include rigorous travel, observation, written/**drawn** analysis & interpretation, photographic documentation, and measurement. The professor will travel and participate in all field study.

## T e x t s

Calvino, Italo. *Invisible Cities*. **ISBN-10:** 0156453800

Jellicoe, Geoffrey and Susan. *The Landscape of Man: Shaping the Environment from Prehistory to the Present Day*. **ISBN-10:** 0500278199

Newton, Norman. *Design on the Land: The Development of Landscape Architecture*. **ISBN-10:** 0674198700

Olin, Laurie. *La Foce: A Garden and Landscape in Tuscany*. **ISBN-10:** 0812235932

Sullivan, Chip. *Garden and Climate*. **ISBN-10:** 0070271038

Thacker, Christopher. *The History of Gardens*. **ISBN-10:** 0520056299

Treib, Marc. *Thinking Through Drawing in an Electronic Age*. **ISBN-10:** 0415775612

Treib, Marc. *Representing Landscape Architecture*. **ISBN-10:** 0415700434

• Several additional items provided by the professor

## A d d i t i o n a l   R e c o m m e n d e d   R e f e r e n c e s

Spacemaker Press Series. The entire series.

Ackerman, James S. *The Villa, Form and Ideology of Country Houses*, Princeton Univ. Press, 1990. Chaps. 1, 2, 3, 7

Byrd, Warren T. Jr. and Nelson, Susan S. *On Drawing*, Landscape Architecture Magazine. July/August 1985. Pages 44 – 54

Coffin, David R. *The Villa in the Life of Renaissance Rome*, Princeton, 1979. Pg. 9 - 22, Chapter 1; Pages 281-361, Chapter 9

Forman, Richard T.T. & Michel Godron. *Landscape Ecology*, New York: John Wiley & Sons, 1986.

Graves, Michael. *The Necessity for Drawing: Tangible Speculation*, Architectural Design Magazine. June 1977. Pages 384-394

Harley, J. B. *Maps, Knowledge, and Power. The Iconography of Landscape*.

Hazlehurst, Hamilton F. *Gardens of Illusion, The Genius of Andre Le Nostre*, Vanderbilt University Press, Nashville Tenn. 1980

Keim, Kevin P. and Kohlhaas, Kimberly R. *Architectural Traveler, Travels With Charles*, Inland Architect, July/Aug., 1993. Pages 69 – 73

Lazzaro, Claudia. *The Italian Renaissance Garden*, Yale University Press, New Haven and London, 1990

Le Corbusier. *Journey to the East*, translated by Ivan Zaknic. MIT Press, Cambridge, Mass.

Meinig, D.W. *The Beholding Eye. Ten versions of the Same Scene. The Interpretation of Ordinary Landscapes*. Geographical Essays.

Solomon, Barbara S. *Green Architecture and the Agrarian Garden*

Tanzer, Helen H. The Villas of Pliny the Younger. (Pliny's two letters: Book II, Letter 17 and Book V, Letter 6)

Thiebaud, Wayne. *Vision and Revision*

Thompson, William. *Sketching Summit and Portfolios*, Landscape Architecture Magazine, May, 1993. Pages 48 - 63

Woodbridge, Kenneth. *Princely Gardens. The Origins and Development of the French Formal Style*, New York, 1986. Pages 39 - 95

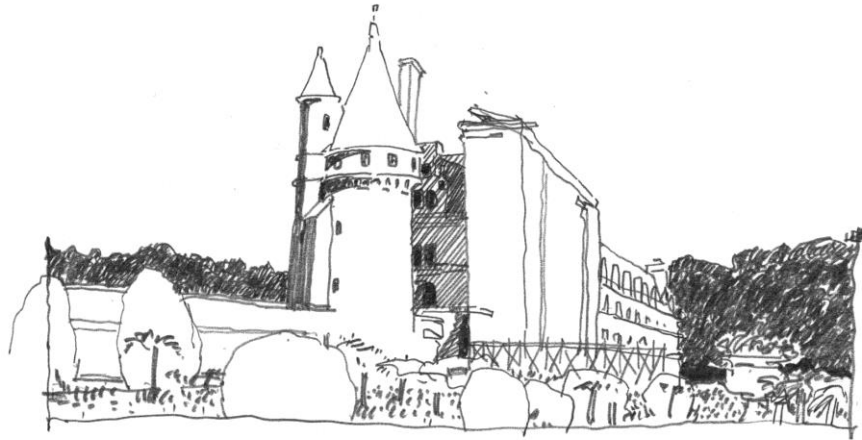

### Additional Class Material

- Sketchbook – minimum size 8” x 8” (80 pages).
- Every student is strongly encouraged to have a digital SLR (DSLR) camera.
- All travel necessities.

### Course Topics/Weekly Schedule

- Spring semester (hours: TBA): Logistical preparation, research, techniques, and overview of landscape architecture history in Italy and France.
- May-June: Travel, see attached itinerary.
- Remainder of 12-week summer term (hours: TBA): Studio workshop and lecture.

Spring semester weekly topics:  
1)introduction, 2)graphite techniques,  
3)ink techniques, 4)Prismacolor  
technique, 5)watercolor drawing,  
6)watercolor painting, 7)plan drawing,  
8)section drawing, 9)elevation drawing,  
10)perspective drawing, 11)isometric  
drawing, 12)axonometric drawing,  
13)photography equipment,  
14)photography technique, 15)field study  
discussion

### I n s t r u c t i o n a l M e t h o d o l o g y

The class will meet for a one hour lecture each week of the spring semester at a mutually agreed upon time/day/place. At the commencement of the summer semester the class will participate in three weeks of travel to important landscape architectural works – expect long **[16 hour]** days. Upon return, the remainder of the summer term will be spent, in the design studio, synthesizing the pre-travel discussions and the activities during the travel - culminating in the required projects for the class.

### M e t h o d o f E v a l u a t i o n

Traditional grading - course letter grade, averaging four assigned projects (25% each). Assigned projects are to be researched and initiated before and during the study tour and completed during the remainder of the summer semester.

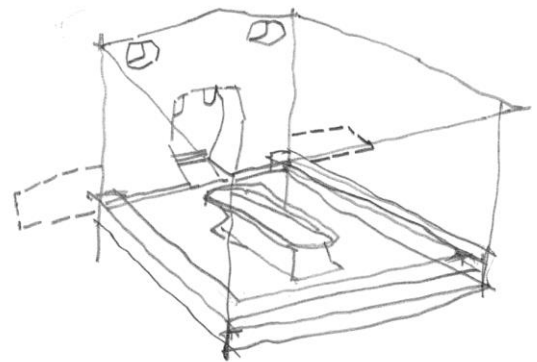
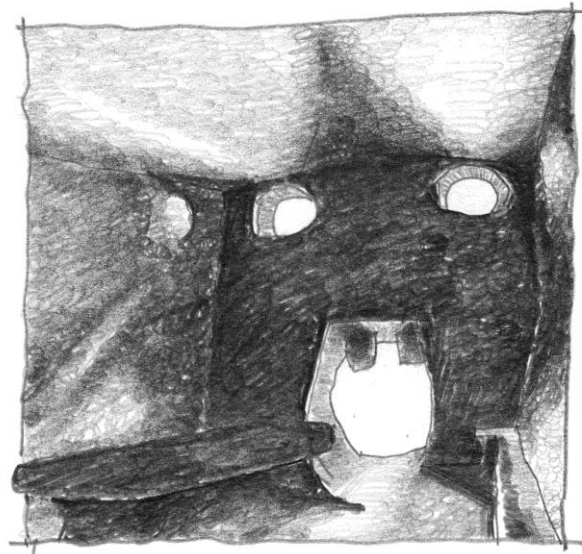



## Field Study/Course Content

In Europe, participants explore periods of Landscape Architectural theory and practice that have had, and will continue to have a substantial impact on landscape architectural theory and practice throughout the world. New revelations about theory will occur through the interpretation and representation of design precedents.

### I. Influential periods of western landscape architectural theory and precedent.

- A. Landscape Design of the Italian Renaissance
  - 1. Rome and vicinity: Villa Medici Rome, Villa D'Este Tivoli, Villa Lante, Villa Guilia, Bomarzo Sacro Bosco, Vatican City, Campidoglio, Piazza Navona
  - 2. Florence and vicinity: Villa Medici Fiesole, Villa Medici Pratolino, Villa Garzoni, Villa Gamberaia, Boboli Gardens & Pitti Palace
- B. French Landscape Design of Andre LeNotre
  - 1. Paris and vicinity: Versailles, Vaux-le-Vicomte, Fontainebleau, Chantilly, Sceaux, Saint - Cloud
  - 2. Tours and vicinity: Bloise, Amboise, Chenonceau
- C. Normandy (WWII) landscape

### II. Urban structure and specific landscape settings.

- A. Ancient designed landscapes of Italy.
  - 1. Hadrians Villa
  - 2. Roman Forum
  - 3. Circus Maximus
  - 4. Siena
  - 5. Assisi
- B. Modern designed landscapes of France.

- 1. Parc des Butte Chaumont
- 2. Parc de la Villette
- 3. Parc Andre Citroen
- 4. Promenade des Plantes
- 5. Parc de Bercy
- 6. Annual festival des Jardins
- C. Cities of Europe.

- 1. Venice
- 2. Rome
- 3. Florence
- 4. Monaco
- 5. Paris

### III. Urban ecology and human geography.

- A. Ecology of the modern city.
  - 1. Plant communities
  - 2. Animal communities
- B. City growth patterns and human & environmental influence.
  - 1. Venice
  - 2. Rome
  - 3. Florence - birth of the renaissance
  - 4. Paris - Napoleon III: urban conditions
- C. Human settlements (communities)
  - 1. Cultivated landscapes
  - 2. Hamlets
  - 3. Villages
  - 4. Suburbs
  - 5. Cities
  - 6. Megalopolis

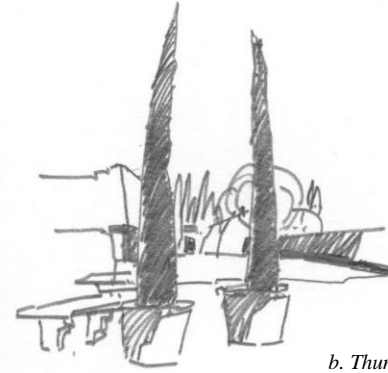

Actual size:  
 a. US Postage Stamp  
 b. Thumbnail gesture sketch

## Projects

Student's grades will reflect evaluation, based on content and presentation, of the following assigned projects (to be turned in on one CD or DVD):

**1.** Sketchbook works of landscape architecture in Europe. Electronic format – scan your entire sketchbook to present in .pdf or .ppt format.

- Annotated drawings which may take the form of plans, sections, elevations, perspectives, thumbnail compositional studies, or combinations of all
- Analyze, describe, and evaluate the subject and/or any other important characteristics of the scene or situation
- Scale, texture, depth, perspective, proportion, light and shade, spatial relationships
- Thoughts / notations / experiences in sketch format

**2.** A seven to ten page paper on the development and situation of one designed landscape. The paper will be word-processed with two columns of text per (8 ½" x 11") page and images inserted - column width should be 3 inches with a ½ inch space between the two columns. Maximum image size should be 2 inches tall by 3 inches wide. Borders around all sides of the page should be 1 inch. Line spacing should be 1-½, and there should be a minimum of seven images included and referenced. A bibliography is required. The content should include a formal (about the form) analysis, historical overview, and evaluation.

–Or –

**2.** 'Pop-up' sequence of landscape experience  
 (See Chip Sullivan examples for reference on:  
<http://gonzogardens.com/> )

**3.** A three-dimensional Scale study model (or digital model) for desktop study, review, and critique of a designed landscape visited during the study tour.

**4.** Digital presentation of course works. A collection including sketchbook work, photographic work, the seven to ten page paper, and the three-dimensional work. Electronic format – presentation in .pdf or .ppt format.

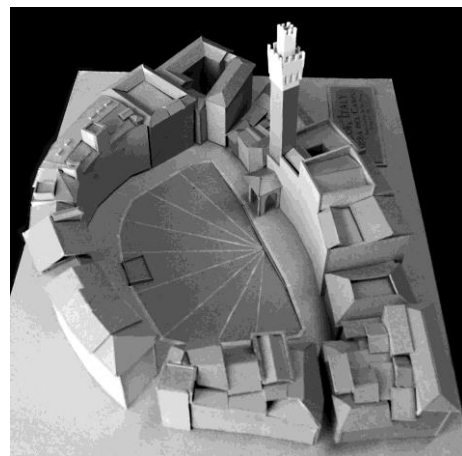

Siena by Neil Podall

## Recommended travel guides

- Michelin Guides
- *Let's Go ...Europe*. Published by Harvard University

## Travel gear and space constraints

Due to the spatial constraints of ground transportation, each person is limited to a maximum of 3 cubic feet of luggage (including camera bags). It is suggested that participants pack lightly with clothing capable of being layered. A wide range of climatic conditions should be expected. Rain, high temperatures, and wind are common. A comfortable pair of walking shoes is necessary.

## Accommodations

Primary accommodations during the trip include one-week rental properties. Hotel stays will be less frequent. Week long rental properties provide the opportunity to settle belongings in a single place, and to live within the cultural environment of the host country. Day trips from the properties are very flexible in terms of organization and destination. Rental properties are determined based on two things - first, a central location to the intended destinations and second, cost (generally less than hotels for the same period of time).

## Identification sharing

Prior to departure, please consider making copies of important documents (names, numbers, etc.) to share with other participants. Consider the following items:

- Passport
- U.S. Drivers License
- Important phone numbers
- Any other important information

## Currency exchange

The best exchange rates tend to be in the States before departure. Each student will need currency in Euros for the majority of the European Union. If travel beyond the group experience is expected, please check for accepted currency in host countries. Visa and American Express credit cards, as well as traveler's checks, are occasionally accepted. Exchange with traveler's checks may be difficult (based on the availability of exchange offices) and will often include higher fees or worse rates than other alternatives.

## International Student Identification Card

Each student is encouraged to obtain an International Student Identification Card (about \$25) before departure – please visit with the Office of International Programs.



Day	Date	Destination	<i>(italics = time permitting)</i>	Night stay
Wednesday	<b>16 May</b>	Leave United States for Europe		
Thursday	<b>17 May</b>	Arrive destination		- by student
Friday	<b>18 May</b>	Venice●, meet in the Piazza San Marco @ noon, visit city.		Venice
Saturday	<b>19 May</b>	Venice to Tuscany, <i>Pratolino, Verona</i> ●		Tuscany
Sunday	<b>20 May</b>	Hadrians Villa●, Tivoli; Villa D'Este, Tivoli●; <i>Villa Aldobrandini, Frascati</i>		Tuscany
Monday	<b>21 May</b>	Siena●; <i>San Gimignano</i> ●		Tuscany
Tuesday	<b>22 May</b>	Rome●. Vatican City● - St. Peters Cathedral and piazza; Campidoglio, Capitoline Hill; Roman Forum; Circus Maximus, Coliseum; Piazza Navona; Villa Guilia; Spanish Steps; Villa Medici; Pantheon		Tuscany
Wednesday	<b>23 May</b>	Villa La Foce		Tuscany
Thursday	<b>24 May</b>	Villa Gamberaia, Settignano; Florence Center●, Boboli Gardens & Pitti Palace		Tuscany
Friday	<b>25 May</b>	Parco de Mostri, Bomarzo; Villa Lante, Bagnaia; <i>Villa Farnese, Caprarola; Civita</i>		Tuscany
Saturday	<b>26 May</b>	Tuscany to France via French Riviera, Monaco		Valence
Sunday	<b>27 May</b>	Versailles until sunset●		Paris
Monday	<b>28 May</b>	Chartes●, <i>Caves of Lascaux-Grottoes of the Vézère Valley</i> ●		Paris
Tuesday	<b>29 May</b>	Normandy, American Memorial, Omaha Beach, American Cemetery, Mont St. Michel●		Paris
Wednesday	<b>30 May</b>	Loire Valley●, Chenonceau, Chaumont Sur Loire, <i>Villandry, Blois, Amboise, Chateau de Chambord</i>		Paris
Thursday	<b>31 May</b>	Old City Paris● - Urban Design: Parc de Sceaux, Arc de Triomphe, Champs Elysees, Jardin de Tulleries, Louvre, Notre Dame, Luxembourg Garden, Eiffel Tower		Paris
Friday	<b>1 June</b>	Modern City - Paris Gardens: Parc Des Butte Chaumont, Parc De La Villette, Parc Andre Citroen, le jardin des Plantes, parc Diderot, La Defense, Parc de Bercy, Jardin Atlantique (Gare Montparnasse), UNESCO Garden		Paris
Saturday	<b>2 June</b>	<i>EuroDisney Master Plan</i> , Fontainebleau●, Vaux le Vicomte, candlelight evening		Paris
<b>Sunday</b>	<b>3 June</b>	<b>Paris to Denver</b>		Ch. de Gaulle
Friday	<b>3 Aug</b>	assignments due 4:00 room 111 Shepardson Hall		

● = UNESCO World Heritage Sites

Estimated Cost Per Student - Based on *eight* students per van, and *one* instructor (9 passenger van - eight is the maximum number of student participants per van).

The following items to be addressed at the Division of Continuing Education (DCE) and the Office of International Programs:

Tuition (5 credit hours, through DCE - \$466/credit)	\$2330.00
Fees (estimate) - Ground transportation, Accommodations, Other (to cover entry prices, fuel, other misc. group costs). Excess to be refunded to students upon return	\$2230.00
CSU Office of International Programs (OIP) admin. fee	\$350.00
<b>Estimated PROGRAM cost per student</b>	<b>\$4910.00</b>

**Items below need to be arranged by the participant:**

Estimated Air Transportation (by student) – <b>Please make arrangements to meet in the Piazza San Marco, Venice at noon on Friday MAY 18.</b>	\$400.00-\$1000.00
<i>Other</i> - estimated individual food, digital media, souvenirs and other travel essentials (allow \$200+ per week abroad, by student)	\$600.00
Estimated total cost per student	\$5910.00+

**Registration and payment structure**

Registration forms (binding contract with the University) are available online with the Office of International Programs - \$350 (deposit + registration fee). International Programs fee includes \$45 (approx.) HTH Worldwide: Blanket Student Accident and Sickness Insurance.

**Deadline: First week-February.**

**Payment Structure:** Charge to student account in May (less the deposit).

The estimated cost is based on eight student participants per van and is subject to change. If change is anticipated, a meeting will be held prior to the registration deadline.

**Financial Aid - Travel Scholarships, Grants, Academic Loans**

Please direct inquiry to:

- Study Abroad resources
- Office of Financial Aid
- The Pell Grant – <http://www.thepellgrant.com/pell-grant-eligibility.shtml>
- Landscape Architecture Foundation – <http://www.lafoundation.org/scholarship/>